



## CLP3 DC LINEAR SOLENOID

### Availability

For DC only.

PULL - THRUST - PULL & THRUST

For operation over 50V  
please enquire as to feasibility.

**Solenoid shown in  
energised position**

Weight complete 70g  
Plunger weight 7g max

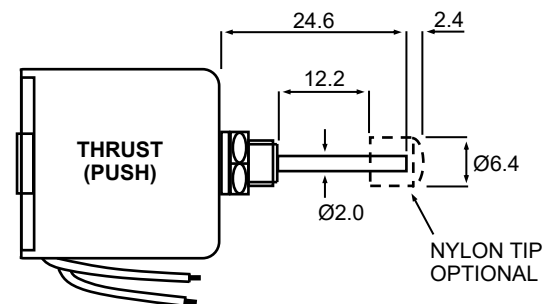
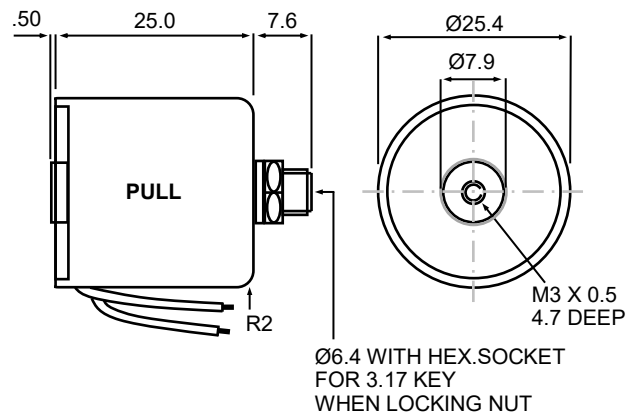

LEADS 24AWG - 200

DIMENSIONS IN MM

Forces shown are at  
working temperature  
Cold forces are higher

### DC Watts

100% Rtg = 3.5W

50% Rtg = 7W

25% Rtg = 14W

10% Rtg = 35W

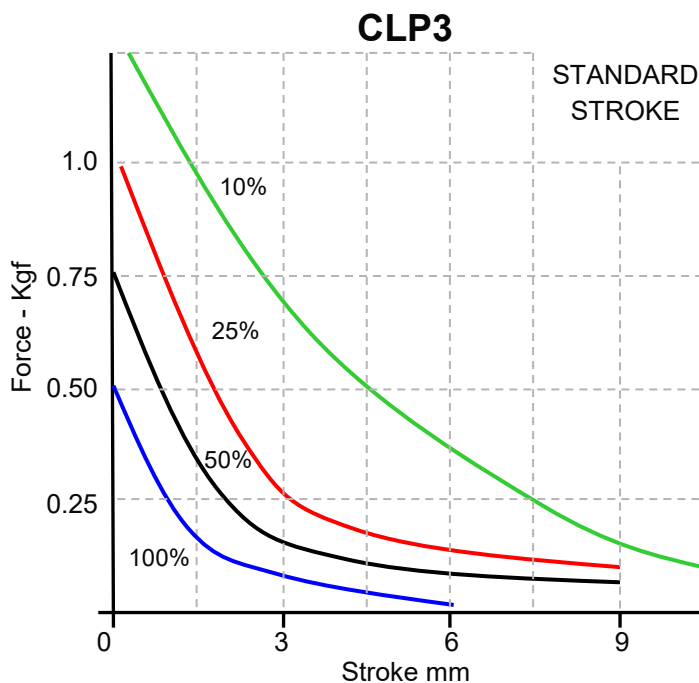

**\*\* Please note: Fixing, plunger coupling, thrust rods and lead length can all be customised \*\***  
*We reserve the right to alter or amend designs without prior notice.*

**HE & BS Benson Ltd**

1 Laureate Industrial Estate, Exning Road, Newmarket, Suffolk UK CB8 0AR

+44(0)1638 663535 — 663130 ✉ sales@bensonsolenoids.co.uk 🌐 www.bensonsolenoids.co.uk

## CODING

Please use the standard coding below when advising your design requirement.

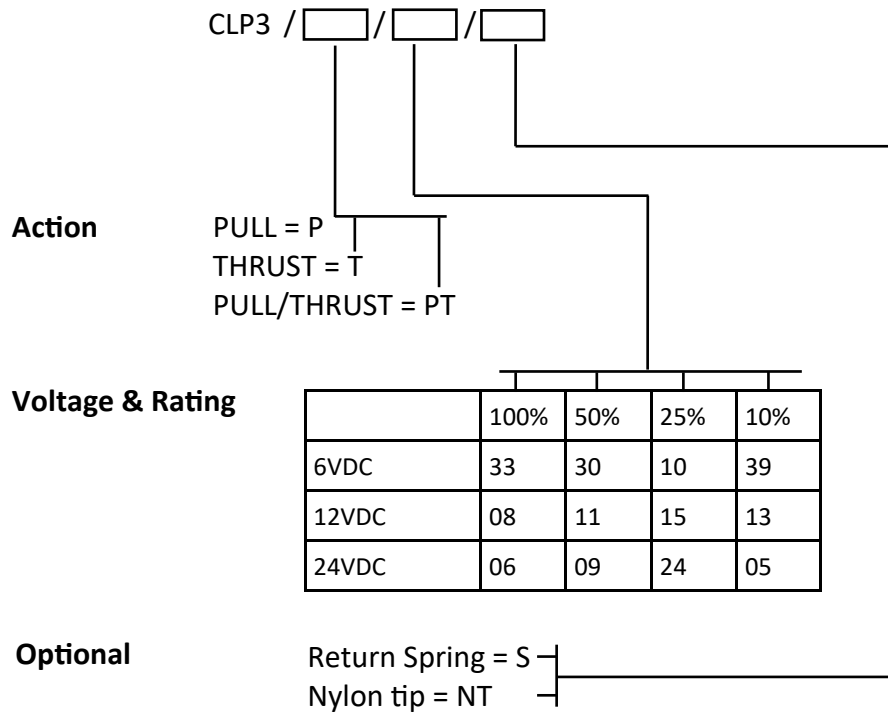

*Example - CLP3 / P / 15 / S*

Other voltages are available on request.

Fixing, plunger coupling, thrust rods and lead length can all be customised.

**\*\* Please note: Fixing, plunger coupling, thrust rods and lead length can all be customised \*\***  
*We reserve the right to alter or amend designs without prior notice.*

**HE & BS Benson Ltd**

**1 Laureate Industrial Estate, Exning Road, Newmarket, Suffolk UK CB8 0AR**

**+44(0)1638 663535 — 663130 ✉ sales@bensonsolenoids.co.uk 🌐 www.bensonsolenoids.co.uk**

CLP3 Rev 5 - 2016